

MOF45 Face Mill (05 type / 07 type)

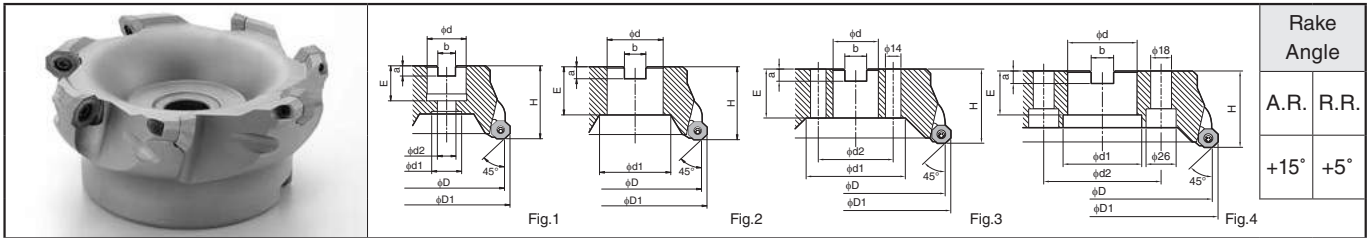

Toolholder Dimensions

Description	Std.	No. of Inserts	Dimension (mm)											Drawing	Weight (kg)	Applicable Inserts ● M21			
			φD	φD1	φd	φd1	φd2	H	E	a	b	S							
Metric	MOF	45040R-05-3T-M	●	3	40	49	16	13.5	8.5	40	19	5.6	8.4	-	Fig.1	0.3	OFMT05 type		
		45050R-05-4T-M	●	4	50	59	22	17	11									21	6.3
		45063R-05-5T-M	●	5	63	72				50	24	7	12.4						
		45080R-05-6T-M	●	6	80	89	27	20	13						32	8		14.4	1.1
		45100R-05-7T-M	●	7	100	109				32	45	-	33						
		45125R-05-8T-M	●	8	125	134	40	55	63						30	3.7			
		45160R-05-10T-M	●	10	160	169				40	88	66.7	38					14	25.7
	45200R-05-12T-M	●	12	200	209	60	68	101.6	38					14	25.7	8.0			
	MOF	45063R-07-4T-M	●	4	63	75	22	17	11	40	21	6.3	10.4	-	Fig.1	0.6		OFMT07 type	
		45080R-07-5T-M	●	5	80	92	27	20	13	50	24	7	12.4						1.2
		45100R-07-6T-M	●	6	100	112	32	45	-	32	8	14.4	1.9						
		45125R-07-8T-M	●	8	125	137	40	55	63	33	9	16.4			3.7	Fig.2			
		45160R-07-10T-M	●	10	160	172							40						88
		45200R-07-12T-M	●	12	200	212	60	68	101.6	38	14	25.7			8.0				
Bore Dia. Inch spec		MOF	45080R-05-6T	○	6	80	89	25.4	20	13	50	26	6		9.5	-	Fig.1		1.1
	45100R-05-7T		○	7	100	109	31.75	45	63	32				8				12.7	
	45125R-05-8T		○	8	125	134	38.1	55			38	10	15.9		3.7				
	45160R-05-10T		○	10	160	169	50.8	88	14	25.4				5.1					
	45200R-05-12T		○	12	200	209	47.625	68			101.6	14	25.4		8.0				
	MOF	45080R-07-5T	○	5	80	92	25.4	20	13	50	26	6	9.5	-	Fig.1	1.2	OFMT07 type		
		45100R-07-6T	○	6	100	112	31.75	45	63									32	8
		45125R-07-8T	○	8	125	137	38.1	55		38	10	15.9	3.7						
		45160R-07-10T	○	10	160	172	50.8	88	14						25.4	5.1			
		45200R-07-12T	○	12	200	212	47.625	68		101.6	14	25.4	8.0						

Spare Parts

Description	(1) Clamp Screw	(2) Wrench	Mounting bolt
MOF 45040R-05-3T-M	SB-4082TPR	DTP-15	HH8X25
45050R-05-4T-M			HH10X30M
45063R-05-5T-M			HH12X35M
45080R-05-6T-M			-
45100R-05-7T-M			-
45125R-05-8T-M			-
45160R-05-10T-M			-
45200R-05-12T-M	-		
MOF 45063R-07-4T-M	SB-50120TRS	DTP-15	HH10X30S
45080R-07-5T-M			HH12X35M
45100R-07-6T-M			-
45125R-07-8T-M			-
45160R-07-10T-M			-
45200R-07-12T-M			-
MOF 45080R-05-6T	SB-4082TPR	DTP-15	HH12X35M
45100R-05-7T			-
45125R-05-8T			-
45160R-05-10T			-
45200R-05-12T			-
MOF 45080R-07-5T	SB-50120TRS	DTP-15	HH12X35M
45100R-07-6T			-
45125R-07-8T			-
45160R-07-10T			-
45200R-07-12T			-

Max. ap and usable edges

Usable edges	MAX. ap	
	OFMT05 type	OFMT07 type
4 edges	7mm	10mm
8 edges	2.5mm	4mm

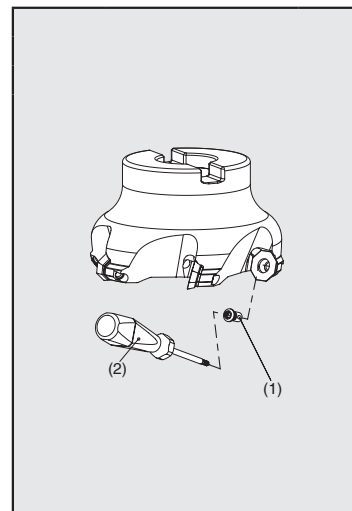

● : Std. Item

M

Milling

Inserts

Lead Angle 45°/20°

Lead Angle 15°

Lead Angle 0°

High Feed

Multi-Function

Slot Mill

Ball-nose Radius

Others

General purpose “SH Chipbreaker”, Tough Edge type “GT Chipbreaker”

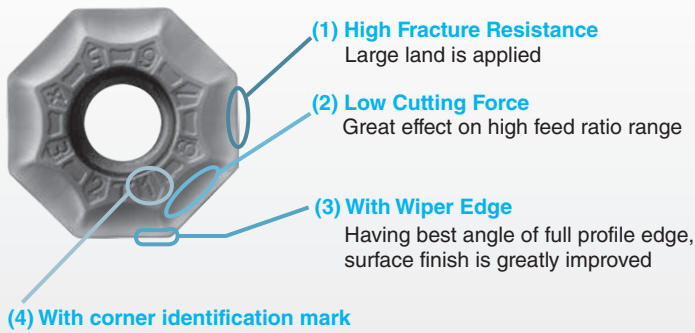

	OFMT05 type	OFMT07 type
GT Chipbreaker (Tough Edge)		
SH Chipbreaker (General purpose)		

Note 1) OFMT07 type inserts cannot be used for MOFX cutters (Ref. to page M36).

Applicable Chipbreaker Range

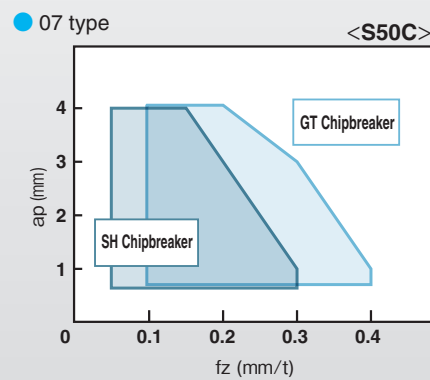
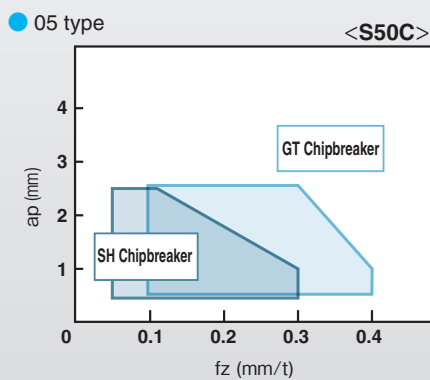

Recommended Cutting Conditions (MOF / MOFX)

Workpiece Material	fz (mm/t)		Recommended Insert Grades (Cutting Speed Vc: m/min)		
	GT Chipbreaker (Tough Edge)	SH Chipbreaker (General purpose)	MEGACOAT		PVD Coated Carbide
			PR1225	PR1210	PR830
Carbon Steel	0.10~0.25~0.40	0.10~0.15~0.30	★ 120~180~250	-	☆ 120~150~200
Alloy Steel	0.10~0.25~0.35	0.10~0.15~0.30	★ 100~160~220	-	☆ 100~150~180
Mold Steel	0.10~0.20~0.35	0.08~0.12~0.25	★ 80~140~180	-	☆ 80~120~150
Stainless Steel	-	0.08~0.12~0.25	★ 120~160~220	-	-
Gray Cast Iron	0.10~0.25~0.40	0.10~0.15~0.30	-	★ 120~180~250	-
Nodular Cast Iron	0.10~0.20~0.35	0.08~0.12~0.25	-	★ 100~150~200	-

★:1st Recommended ☆:2nd Recommended

M



Milling