

diameter X fyrkant	DIN 371 förstärkt skaft	DIN 376 reducerat skaft	ISO 529 förstärkt skaft	ISO 529 reducerat skaft	0	1	2	3	4
					M1-M8	M1-M14	M8-M24	M14-M36	M22-M48
2,5 X 2			M1/1,1/1,4/ 1,6/1,8/2		X	X			
2,5 X 2,1	M1/1,1/1,2/ 1,6/1,7/1,8	M3,5			X	X			
2,8 X 2,1	M2/2,2/2,3/ 2,5/2,6	M4			X	X			
2,8 X 2,24			M2,2/2,5		X	X			
3,15 X 2,5			M3		X	X			
3,5 X 2,7	M3	M4,5/5			X	X			
3,55 X 2,8			M3,5		X	X			
4 X 3,15			M4		X	X			
4 X 3	M3,5				X	X			
4,5 X 3,4	M4	M6			X	X			
4,5 X 3,55			M4,5		X	X			
5 X 4			M5		X	X			
5,5 X 4,3		M7			X	X			
5,6 X 4,5			M5,5		X	X			
6 X 4,9	M4,5/5/6	M8			X	X			
6,3 X 5			M6		X	X			
7 X 5,5	M7	M9/10			X	X			
7,1 X 5,6			M7		X	X			
8 X 6,3	M8	M11	M8	M11	X	X	X		
9 X 7,1	M9	M12	M9	M12		X	X		
10 X 8	M10		M10			X	X		
11 X 9		M14				X	X	X	
11,2 X 9				M14/15		X	X	X	
12 X 9		M16					X	X	
12,5 X 10				M16			X	X	
14 X 11		M18					X	X	
14 X 11,2				M18/20			X	X	
16 X 12		M20					X	X	
16 X 12,5				M22			X	X	X
18 X 14				M24			X	X	X
18 X 14,5		M22/24					X	X	X
20 X 16		M27		M27/30				X	X
22 X 18		M30/32						X	X
22,4 X 18				M32/33				X	X
25 X 20		M33		M36				X	X
28 X 22		M36						X	X
28 X 22,4				M39/42				X	X
31,5 X 25				M45/48					X
32 X 24		M39/42							X
36 X 29		M45/48							X

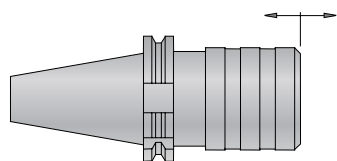

Flytande gängchuck  
GS/NCL - DIN 69871 A

Best. Nr.	Pris
GS/NCL-1 6930	4083,00
GS/NCL-1 6935	4083,00
GS/NCL-1 6940	3738,00
GS/NCL-1 6945	4764,00
GS/NCL-1 6950	6118,00
GS/NCL-2 6930	4875,00
GS/NCL-2 6940	4875,00
GS/NCL-2 6945	5672,00
GS/NCL-2 6950	6799,00
GS/NCL-3 6940	10204,00
GS/NCL-3 6945	11328,00
GS/NCL-3 6950	12469,00
GS/NCL-4 6940	15859,00
GS/NCL-4 6945	15859,00
GS/NCL-4 6950	20394,00

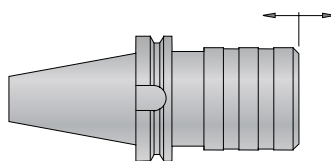

Flytande gängchuck  
GS/NCL - MAS BT 403

Best. Nr.	Pris
GS/NCL-1 BT 30	4315,00
GS/NCL-1 BT 35	4315,00
GS/NCL-1 BT 40	3967,00
GS/NCL-1 BT 45	4764,00
GS/NCL-1 BT 50	6118,00
GS/NCL-2 BT 40	5109,00
GS/NCL-2 BT 45	5898,00
GS/NCL-2 BT 50	7141,00
GS/NCL-3 BT 40	7938,00
GS/NCL-3 BT 45	8500,00
GS/NCL-3 BT 50	10204,00
GS/NCL-4 BT 40	14733,00
GS/NCL-4 BT 45	14733,00
GS/NCL-4 BT 50	18128,00

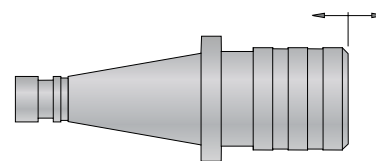

Flytande gängchuck  
GS/NCL - DIN 2080

Best. Nr.	Pris
GS/NCL-1 DIN 30	4532,00
GS/NCL-1 DIN 40	4201,00
GS/NCL-1 DIN 50	7374,00
GS/NCL-2 DIN 30	4764,00
GS/NCL-2 DIN 40	4532,00
GS/NCL-2 DIN 50	6799,00
GS/NCL-3 DIN 40	7938,00
GS/NCL-3 DIN 50	10204,00
GS/NCL-4 DIN 40	12469,00
GS/NCL-4 DIN 50	13592,00

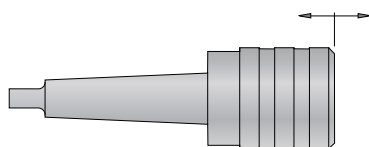

Flytande gängchuck  
GS/NCL - CMB DIN 228 B

Best. Nr.	Pris
GS/NCL-0 CMB 2	3408,00
GS/NCL-1 CMB 2	3408,00
GS/NCL-1 CMB 3	3408,00
GS/NCL-2 CMB 3	3967,00
GS/NCL-2 CMB 4	4532,00
GS/NCL-3 CMB 4	6799,00
GS/NCL-3 CMB 5	9062,00
GS/NCL-4 CMB 5	15859,00
GS/NCL-4 CMB 6	18128,00

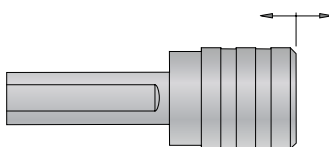

Flytande gängchuck  
GS/NCL - MC cylindriskt skaft

Best. Nr.	Pris
GS/NCL-0 MC 16	3408,00
GS/NCL-0 MC 20	3408,00
GS/NCL-1 MC 16	2844,00
GS/NCL-1 MC 20	2844,00
GS/NCL-1 MC 25	2844,00
GS/NCL-1 MC 32	2844,00
GS/NCL-2 MC 25	3967,00
GS/NCL-2 MC 32	3967,00
GS/NCL-2 MC 40	4532,00
GS/NCL-3 MC 32	7475,00
GS/NCL-3 MC 40	7475,00
GS/NCL-4 MC 32	13592,00

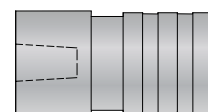

Fast gängchuck  
GS - B DIN 238

Best. Nr.	Pris
GS/0 B 10	1964,00
GS/0 B 12	1841,00
GS/1 B 12	1841,00
GS/1 B 16	1841,00
GS/1 B 18	1841,00
GS/2 B 16	3070,00
GS/2 B 18	3070,00
GS/2 B 22	3070,00
GS/3 B 18	6126,00
GS/3 B 22	6126,00
GS/3 B 24	6126,00

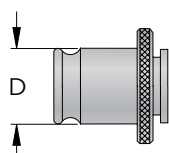

Gängtappshållare  
utan friktionskoppling

Best. Nr.	D	Pris
SE-0.....	13	423,00
SE-1.....	19	423,00
SE-2.....	31	639,00
SE-3.....	48	1789,00
SE-4.....	60	2930,00

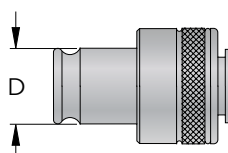

Gängtappshållare  
med friktionskoppling

Best. Nr.	D	Pris
SES-0.....	13	1091,00
SES-1.....	19	1091,00
SES-2.....	31	1624,00
SES-3.....	48	3292,00
SES-4.....	60	4878,00

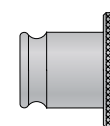

Reducerare

Best. Nr.	Pris
SER-1/0	1140,00
SER-2/1	1372,00
SER-3/2	2050,00
SER-4/3	3408,00

Beställningsexempel: SES-1 8X6.3 (se vänstersidan för val av dimension på tapphållare)